

**TTO** KNOWLEDGE  
IS POWER.



**Function:** Temperature

TEMP RANGE: -40°C/°F to 300°C/575°F

## Use Instructions



**Option 1** PEEL & BOLT-ON  
STICK MOUNTING  
Included M4 (#6) Screws Not Included

**Option 2** BOLT-ON  
MOUNTING

### TEMPERATURE METER:

Press button to toggle 3 main screens:

- |                       |   |
|-----------------------|---|
| <b>1: Temperature</b> | - Hold button to enter setup mode:<br>Choose between °Fahrenheit or °Celsius<br>Edit the High Temperature alert threshold |
| <b>2: Max Temp</b>    | - Hold button to reset the max temperature readout<br>"Hi" appears when temperature is above threshold                    |
| <b>3: Clock</b>       | - Hold button to edit current time of day   |

# Temperature Sensor Installations

## CHT Cylinder Head Spark Plug Sensor Installation:

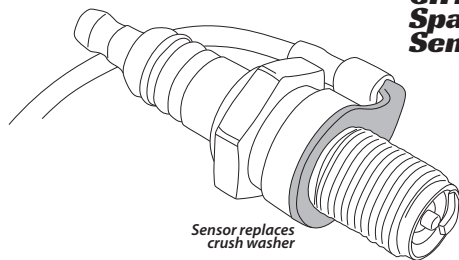

1. Remove crush washer from spark plug
2. Replace with temperature sensor
3. Re-install spark plug

## Radiator Fin Sensor Installation:

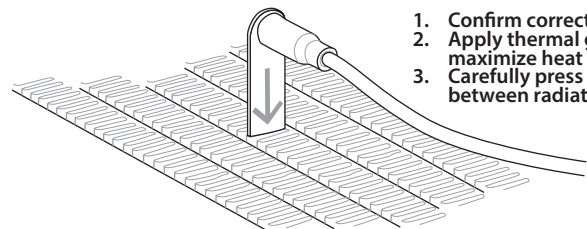

1. Confirm correct size
2. Apply thermal grease to maximize heat transfer
3. Carefully press sensor between radiator fins

## Screw Sensor Installation:

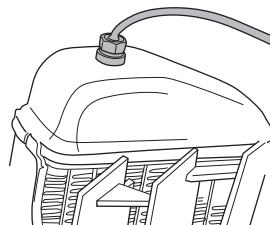

1. Remove stock bolt
2. Replace with sensor bolt  
Use nylon washer to ensure seal

## Radiator Hose Sensor Installation:

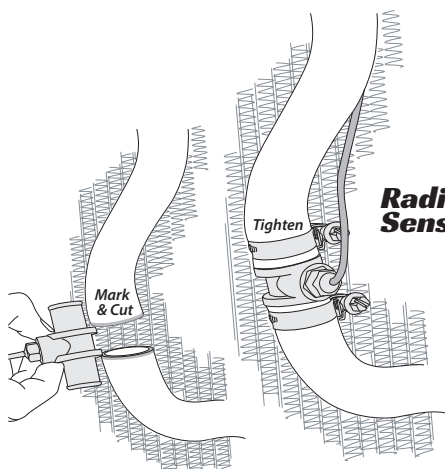

1. Measure inner diameter of hose before cutting
2. Mark hose
3. Cut hose
4. Slide on hose clamps
5. Install sensor & tighten hose clamps

## CVT (Continuously Variable Transmission) Sensor Installation:

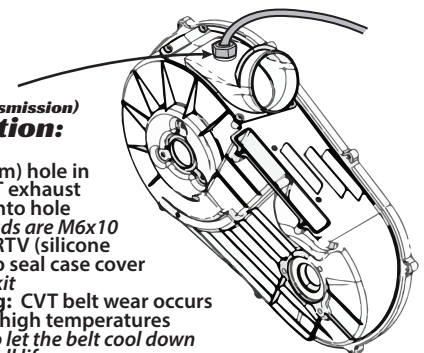

1. Drill 13/64" (5mm) hole in hard plastic CVT exhaust
2. Thread sensor into hole  
The sensor threads are M6x10
3. Use high temp RTV (silicone gasket sealer) to seal case cover  
Not included in kit
4. 200°F+ Warning: CVT belt wear occurs more rapidly at high temperatures  
You may want to let the belt cool down to increase overall lifespan