

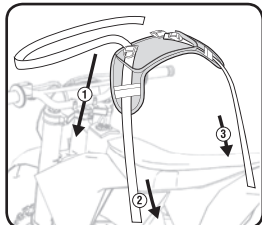

BUCKIN' ROLL TANK BAG

MOUNTING AND INSTALLATION INSTRUCTIONS

! NOTE: Failure to follow recommended mounting and installation instructions voids warranty. Manufacturer is not liable for any damage, injury or death that results from improper use and installation of products. By installing these products, user accepts all liabilities, terms and conditions outlined in the Liability & Warranty statement included here.



THESE INSTRUCTIONS ARE GENERALIZED for Dual Sport/Enduro Bikes. Mounting points vary with every make and model. Take a few minutes to familiarize yourself with the Buckin' Roll Tank Bag and how it will mount to your motorcycle. Find routes for webbing anchor straps that do not abrade, pinch or crimp cables or wires.

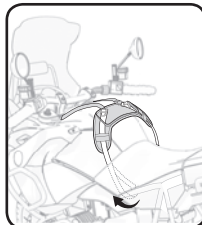

ADVENTURE BIKES

On some adventure touring motorcycles, engine guards and alternative mounting points may be used. For example, remove seat and thread webbing around frame rails. Replace seat, then tighten straps.

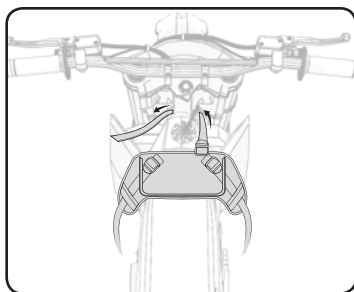

1 Thread the forward webbing under the frame head tube behind steering stops and back into the thumb-lock buckle on harness. Adjust the front mount point to fix the front/back position of the harness to provide fuel fill access and full swing of the handlebars. Do not damage or interfere with any wiring, cables, other controls.

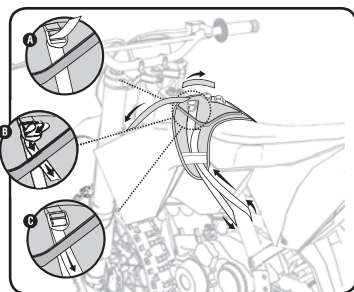

2 Locate the appropriate connection points on each side of frame. Use the farthest forward positions available. Loop each side's webbing straps around frame/subframe and back up through reflective tabs and thumb-lock buckles. DO NOT allow webbing to contact exhaust! Tighten all three points of contact.

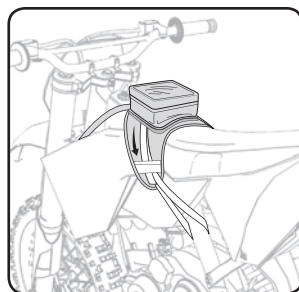

3 Tuck loose webbing ends under reflective tabs and Tank Bag, and zip Tank Bag to harness.

RIDER FRIENDLY DETAILS

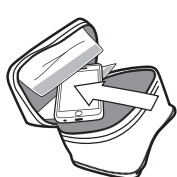

Phone Compartment
Dual hook-and-loop flaps hold your smart phone securely below the waterproof window.



Electronic Pass-Through
Thread power cable through the outside port and into the Tank Bag or Phone Compartment.



Gear Retainers
Dual elastic straps on the bottom hold tools and other valuables securely in place.

PACKING TIPS

- Do not overstuff or over-load Buckin' Roll. The challenge should be to pack as little as necessary to be safe, comfortable and self-sufficient.
- Pack all sharp and/or hard items inside a protective layer. For example, create a sleeve for tire irons from a section of old inner tube, pack tools in rolls and wrap other hard items in clothing.
- Visit our website at GiantLoopMoto.com for more tips.

CARING FOR BUCKIN' ROLL TANK BAG

- Treat zippers with care and respect. Keep them clean and lubricated with zipper wax, such as Zip Care™ Liquid Zipper Cleaner & Lubricant (available at giantloopmoto.com). Don't yank or pull - slliiiiide!
- Avoid sharp metal edges. Protect webbing with inner tube sleeve to prevent abrasion.
- Secure loose webbing ends when riding. Check and retighten all connections at each stop.
- Avoid exposure to insect repellents containing DEET.
- Prevent scuffs and scratches with Vinyl Protective Film.



See giantloopmoto.com/warranty for complete warranty details.

0919



www.giantloopmoto.com | 888-358-8347 | Bend, Oregon USA

GO LIGHT. GO FAST. GO FAR.